



Getting started with  
Logitech® Fold-Up Keyboard



for iPad® 2

# Logitech® Fold-Up Keyboard

---

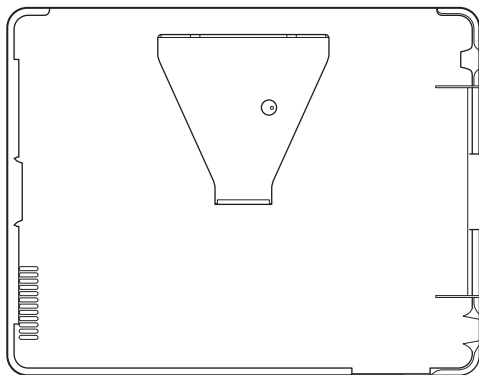

## Setup and turn on

### 1. Insert iPad® 2

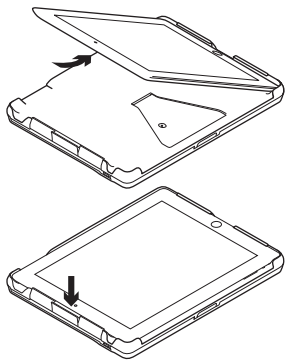

Slide your iPad 2 into the tray. Make sure that the connector port is aligned with the connector opening on the tray. Push the iPad into place. The “Click” lets you know that the iPad is securely attached.

### 2. Open the keyboard

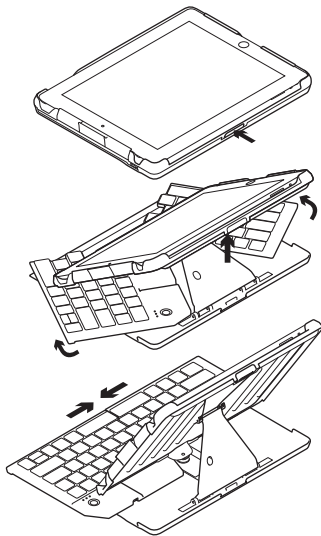

Press the release button and lift the iPad tray to expand the keyboard. The keyboard turns on when it is fully open.

## Pairing the Fold-Up Keyboard

The Bluetooth Fold-Up Keyboard should only need to pair to your iPad 2 once.

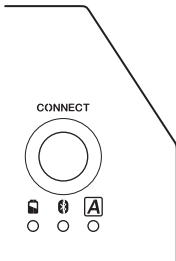

## LED Indicators

### Bluetooth LED

- **Pairing** Blinks while discoverable, or until paired.
- **Power ON** Solid glow for the first six seconds after power on.

1. On the open keyboard, press the **CONNECT** button.

The Bluetooth status light blinks. The keyboard is “discoverable” for three minutes, or until it is paired with the iPad 2.

2. On the iPad 2, select: Settings > General > Bluetooth > On.
3. Select “Logitech Fold-Up Keyboard (IPD)” from the iPad 2 list of available devices. The iPad 2 displays a code.
4. Type the code on the keyboard and press Enter. The Fold-Up Keyboard is paired to the iPad 2.

### Charging LED

- Solid green glow while charging; turns off when fully charged.
- Blinks red when battery status drops below 5%, or less than one hour. LED continues to blink until battery is completely dead and the unit turns off.

## Function keys

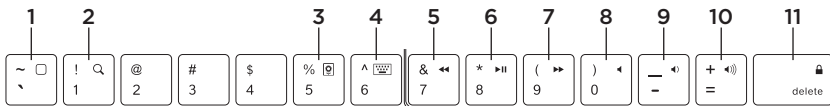

The Fold-Up Keyboard is designed with special function keys (F-key) for more control of your iPad 2. To use the enhanced functions, press and hold the fn key followed by an F-key.

1. **Home** Returns you to the iPad 2 home screen
2. **Search** Brings up the iPad 2 search screen
3. **Slideshow** Starts playing slideshow of saved pictures
4. **Virtual keyboard** Allows you to hide or show iPad 2 onscreen keyboard
5. **Previous track** Skips to previous track on current playlist
6. **Play/Pause** Starts or stops current playlist
7. **Next track** Skips to next track on current playlist
8. **Mute** Mutes audio on iPad 2
9. **Volume down** Decreases volume on iPad 2
10. **Volume up** Increases volume on iPad 2
11. **Lock** Makes the iPad 2 screen go dark and come back when pressed again

## Close and turn off

### 1. Close the keyboard

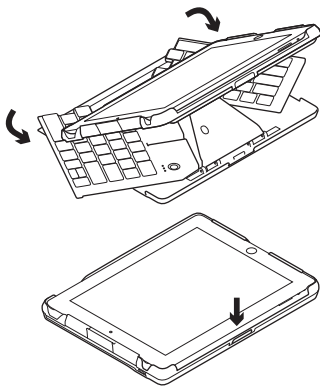

Hold and gently push both front corners of the keyboard towards the back of the unit until completely closed. Closing the unit turns off the keyboard.

#### Caution

- Hold the keyboard until fully closed to prevent the iPad 2 from falling.
- Avoid putting your fingers between the tray and the bottom case to prevent pinching.

### 2. Remove the iPad

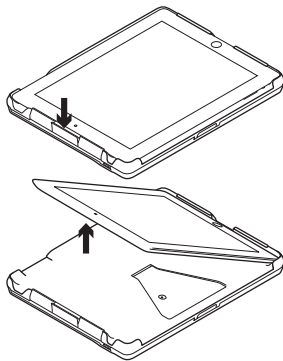

Press down on the iPad release to remove it from the tray.

Tip: During flights, keep keyboard closed.

## Battery Management

The Fold-Up Keyboard features a rechargeable battery.

### Charging information

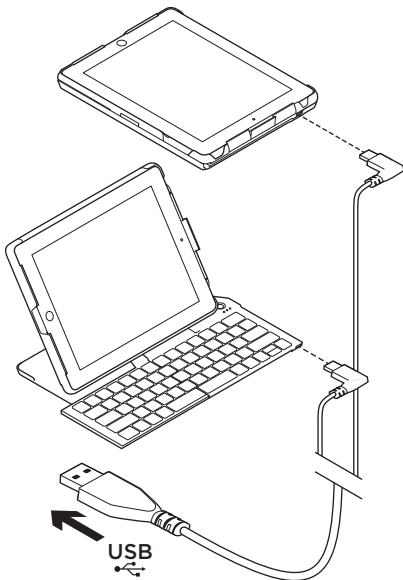

- To recharge the keyboard, use the provided USB cable. Plug the micro USB end into the unit and the other end into an iPad 2 adapter or a computer USB port. The keyboard will charge when open or closed:
- The battery LED is green while charging. It turns off when the keyboard is fully charged.
- It takes about 3 hours to completely recharge the keyboard.
- The battery life is approximately 500 hours of typing.

### **Product end of life: keyboard battery disposal**

Removing the battery requires disassembly and will destroy the unit.

1. Remove each rubber foot located on the bottom of the Fold-Up Keyboard.
2. Remove the screws located below each rubber foot.
3. Turn the unit right side up.
4. Remove the iPad tray.
5. Remove the keyboard from the bottom case.
6. On the bottom of the keyboard, use a tool to break the battery cover.
7. Remove the battery.
8. Dispose of the battery according to local regulations. Recycle the remaining keyboard part..

---

What do you think?

Please take a minute to tell us. Thank you for purchasing our product.

**[www.logitech.com/ithink](http://www.logitech.com/ithink)**







**[www.logitech.com/support](http://www.logitech.com/support)**



United States

+1 646-454-3200



[www.logitech.com](http://www.logitech.com)

© 2011 Logitech. All rights reserved. Logitech, the Logitech logo, and other Logitech marks are owned by Logitech and may be registered. iPad is a trademark of Apple Inc., registered in the U.S. and other countries. All other trademarks are the property of their respective owners. Logitech assumes no responsibility for any errors that may appear in this manual. Information contained herein is subject to change without notice.

620-003641.002